

GRAIN BASKET INSTRUCTION INSERT

FRONT

.....Grain Basket

Please read all instructions before using

- Wash before using.
- Do not touch hot surfaces.
- Allow to cool before removing basket.
- Before serving, be sure food is at safe temperature.
- Avoid using abrasive pads to clean grain basket.

To use Grain Basket with Baby Brezza baby food machine:

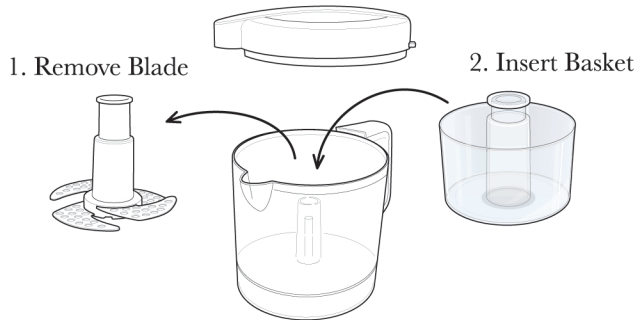

3. Follow cooking instructions on other side.

BACK

Steaming Instructions:

- Remove Lid and Blade from Bowl and insert Grain Basket.
- Open Steam Chamber Lid, add 160ml of water to Steam Chamber, close Steam Chamber Lid.
- Add rice, grain, or pasta and water to Grain Basket per the chart below.
- Replace Bowl Lid and Press “steam” button to select time.
(Do Not Use steam + blend while Grain Basket is in bowl).

Ingredient	Measures	Steam Time
Pasta*	1/2 cup Pasta, 1/2 cup water	20 minutes
Rice	1/2 cup rice, 1/2 cup water	30 minutes
Barley	1/2 cup Barley, 1/2 cup water	30 minutes
Quinoa	1/2 cup Quinoa, 1/2 cup water	30 minutes

*Small pasta shapes cook best in the Grain Basket.

Always consult with your pediatrician regarding questions about solid foods.

- **Cleaning:** Grain Basket is top rack dishwasher safe.