

valco  
baby

PRODUCT REFERENCE GUIDE

SNAP &  
SNAP4  
Stroller

© Copyright  
VE 2012  
vs270412

FURTHER INFORMATION:  
In North America only  
[www.valcobaby.com](http://www.valcobaby.com)  
1800 610 7850

Find us on:



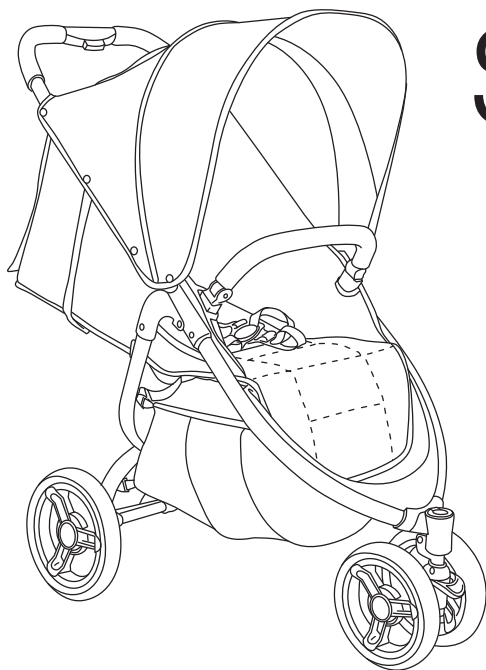

# SNAP & SNAP4

## Stroller

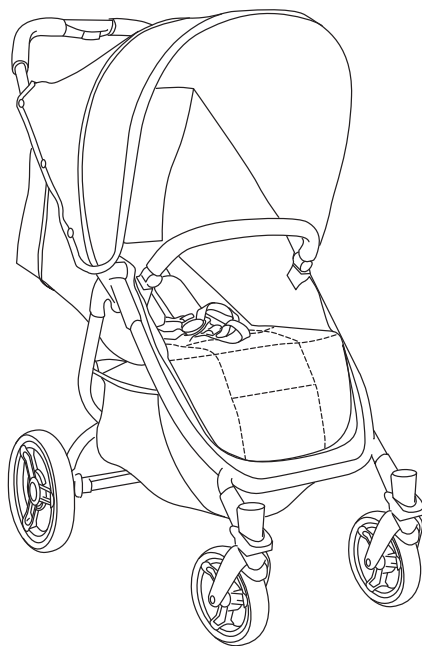

Thank you for purchasing a quality  
VALCO BABY product.

Please read and follow the instructions outlined in  
this guide carefully. Familiarise yourself with the  
construction and safety features; be sure that you  
understand all the warnings and safety  
guidelines before use.



**Important: Please read the following  
instructions carefully before assembling this  
product. Retain this guide in a safe place for  
future reference.**



## DISCLAIMER

Due to our policy of continuous product development, this product is constantly evolving. It is possible that some features or procedures outlined here have changed since this document was written. If you are unsure of any procedure shown here, please contact us via the web at [info@valcobaby.com](mailto:info@valcobaby.com) to obtain the most up to date information before use. Include the batch number and model number, which can be found on a sticker on the frame.

All pictures and diagrams herein are provided for illustration purposes only. Actual product, colour or fabric may vary. VALCO BABY reserves the right to modify or alter any specification or colour without notice or obligation to modify any product previously purchased

## 1>PARTS LIST

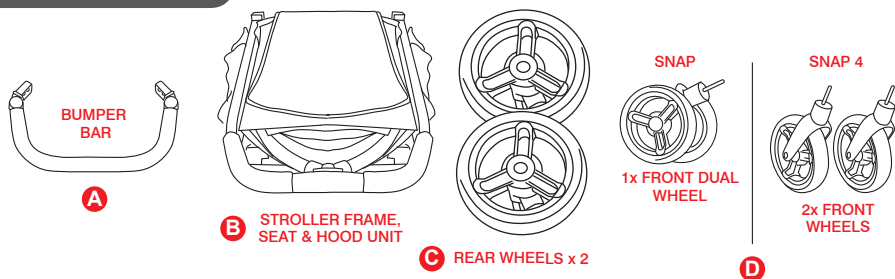

## 2>TO OPEN

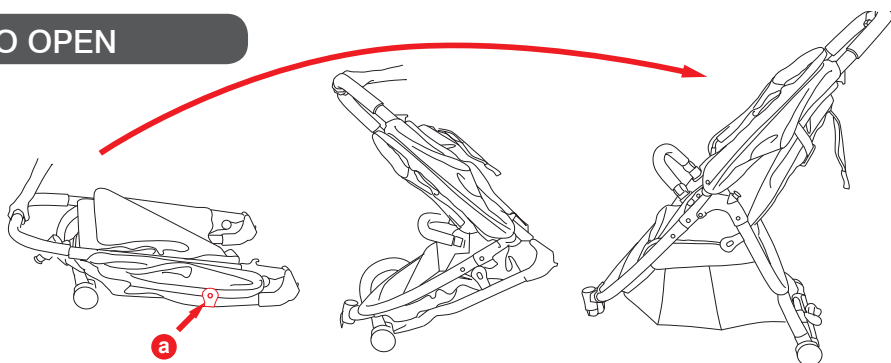

## 3>REAR WHEELS

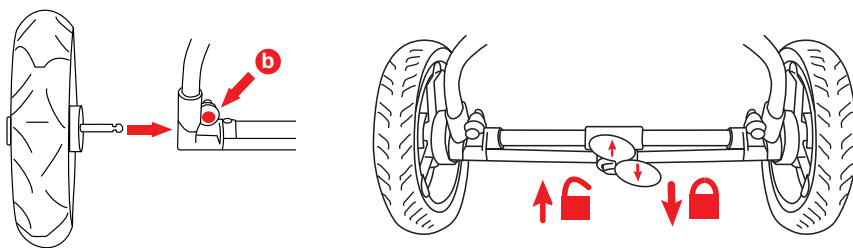

## 4> FRONT WHEELS

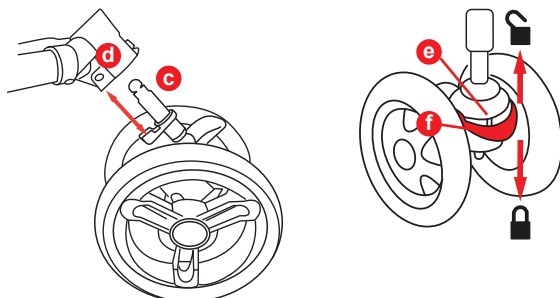

## 5> TO FOLD

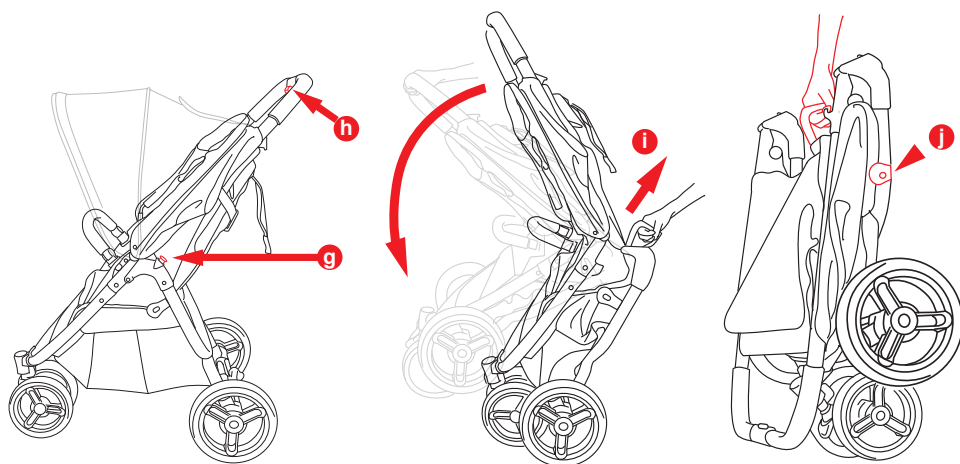

## 6> BUMPER BAR

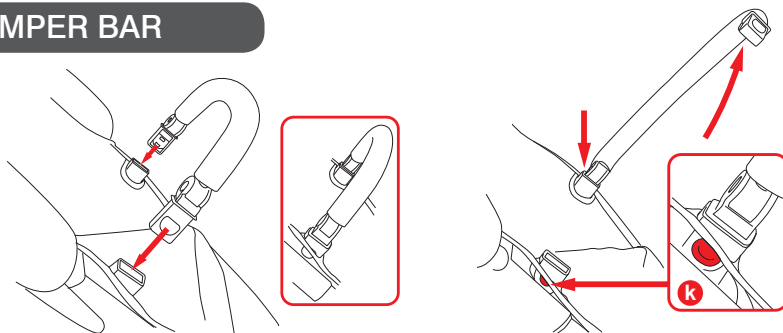

## 7> SEAT RECLINE

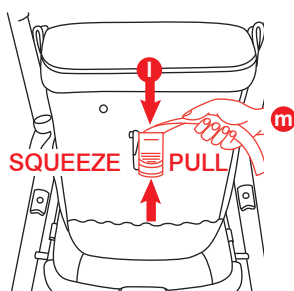

8> HARNESS

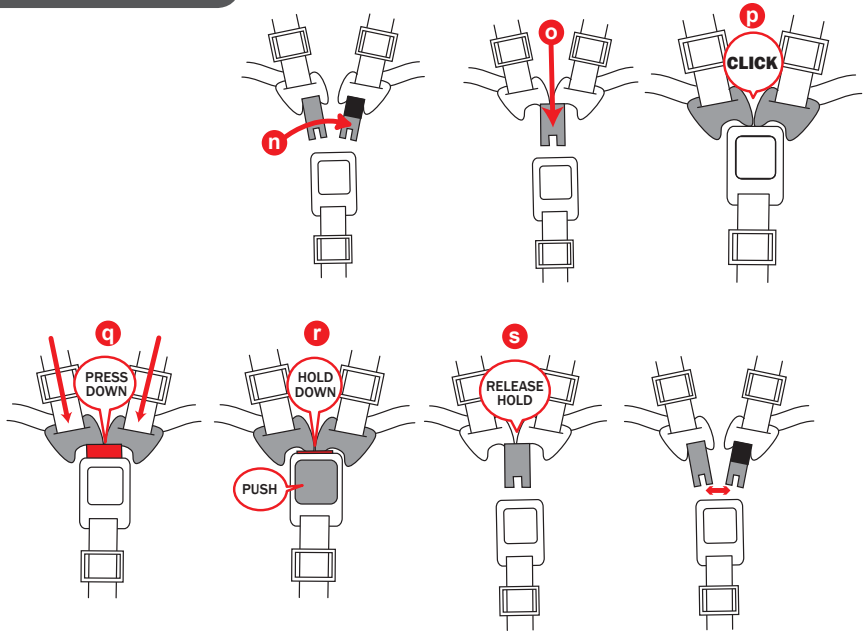

9> HOOD

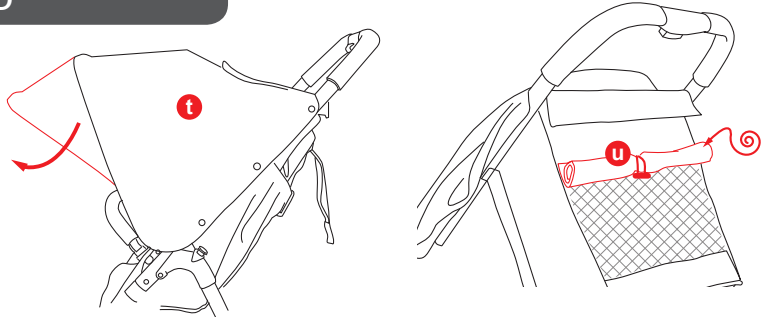

# INSTRUCTIONS

## 1>PARTS LIST

Stroller frame with hood attached, 2x rear wheels, 1x front dual swivel wheel, 1x bumper bar.

## 2>TO OPEN

Release the frame lock (a) by pulling it clear of the locking pin.

Lift the handle in one continuous motion while allowing the legs to simultaneously open. Continue until the frame locks fully open.

**⚠ IMPORTANT WARNING: ALWAYS TEST THAT ALL LATCHES ARE SECURELY ENGAGED BEFORE USE.**

## 3>REAR WHEELS

While depressing the button (b) at the rear axle junction, insert the rear wheel axle into the rear axle tube of the stroller. Push the axle into the tube as far as it will go before releasing the button.

Repeat for other wheel.

To release your wheel, press button (b) and pull from axle tube.

**IMPORTANT: TEST THAT EACH WHEEL HAS FULLY ENGAGED IN THE FRAME TUBE BEFORE USE BY PULLING ON IT.**

To use the rear brakes:

Press down on the right side of the red brake lever located on the rear axle to simultaneously engage the brake in both rear wheels.

To release, press down on the left side of the red brake lever with your foot.

**⚠ IMPORTANT WARNING: ALWAYS TEST THAT THE BRAKES ARE SECURELY DISENGAGED BEFORE USE.**

## 4>FRONT WHEELS

Align each front wheel pin (c) beneath the housing (d) on each front leg of the stroller. Be sure that the pin engages securely in the channel

**IMPORTANT: ALWAYS TEST THAT THE WHEEL HAS SECURELY ENGAGED IN THE CHANNEL BEFORE USE. ENGAGED THE CORRECT WAY UP**

To fix the front wheel in the non-swivel position: Turn the wheel so that the notch at the front of the wheel channel (e) lines up with the one in the top plastic housing (f).

Press down firmly on the tab until it locks into place.

## 5>TO FOLD

Press down on the secondary lock button (g) - it will stay down. Squeeze the fold button in the handle (h), moving the handle forward slightly.

Grasp the folding handle (i) allowing the handle to move all the way forward till the frame automatically locks shut (j).

Your SNAP stroller can stand unaided for easy storage.

**HINT: WHILE NOT NECESSARY FOR FOLDING, MOVING THE SEAT BACK FIRST TO THE MOST UPRIGHT POSITION AND FORWARD THROUGH THE FRAME WILL MAKE FOR THE MOST SIMPLE AND COMPACT FOLDING.**

## 6>BUMPER BAR

Insert each side of the bumper bar fitting into the corresponding housing in the seat frame until you hear a click.

The bumper bar can be opened as a "gate" for easy access pressing on one of the release buttons (k) and lifting the side out of the housing. For full removal, repeat this process for the other side.

## 7>SEAT RECLINE

To recline: While squeezing the seat adjuster tabs (l) together in a pincer like movement, ease the seat down to the desired position. Release the tabs and the seat will automatically lock in that position

To incline: Place your hand in the centre of the seat at the rear.

Pull the incline strap (m) while gently pushing the seat upward to the desired position.

---

## **8>HARNES**

To secure your child in the harness:

Overlap buckles and so that they fit together to form one complete buckle (n).

Insert the completed buckle into the Buckle Housing (o) until it engages securely in place(p).

To open your harness:

Push down on both Buckle Prongs (q).

Simultaneously press the release button in the centre of the buckle (r).

Lift the buckles from the Buckle Housing (s).

**⚠ IMPORTANT WARNING:**

AVOID SERIOUS INJURY FROM FALLING OR SLIDING OUT. ALWAYS USE SEAT BELT.

## **9>HOOD**

Your SNAP hood is designed to provide maximum shade and comfort for your child by incorporating the pop out sun cap (t).

Additional ventilation can be achieved by rolling up the rear of the hood like a blind and securing in the open position with the toggle (u).

# **WARNING: TO AVOID INJURY OR DEATH**

- ALWAYS APPLY THE BRAKES WHENEVER THE PRAM/STROLLER IS STATIONARY
- DO NOT LEAVE CHILDREN UNATTENDED.
- DO NOT CARRY EXTRA CHILDREN OR BAGS ON THIS PRAM/STROLLER.
- MAKE SURE CHILDREN ARE CLEAR OF ANY MOVING PARTS IF YOU ADJUST THE PRAM/STROLLER. OTHERWISE THEY MAY BE INJURED.

 **WARNING: USE THIS HARNESS AT ALL TIMES.**

 **WARNING: WHEN NOT IN USE DISCONNECT SHOULDER STRAPS FROM THE WAIST STRAP AND/OR BUCKLE.**

- FOLLOW THE MANUFACTURER'S INSTRUCTIONS.

**Remember, your child's safety is your responsibility...**

- NEVER USE ON STAIRS OR ESCALATORS.
- ALWAYS USE THE TETHER STRAP WHEN THE STROLLER IS IN USE.
- THE CORRECT USE AND MAINTENANCE OF THIS VEHICLE ARE ESSENTIAL.
- BE SURE THAT ALL CLAMPS AND BUCKLES ARE SECURELY FIXED AND IN PLACE BEFORE USE

 **ALWAYS USE THE HARNESS, CORRECTLY FITTED AND ADJUSTED, WITH YOUR CHILD IN THIS SEAT.**

- THE MAXIMUM WEIGHT OF THE CHILD FOR WHICH THIS STROLLER WAS INTENDED IS 20KGS (44LBS)..
- THE MAXIMUM HEIGHT OF THE CHILD FOR WHICH THIS STROLLER WAS INTENDED IS 90CM (35INCHES).
- THE STROLLER WILL BECOME UNSTABLE IF THE MANUFACTURER'S RECOMMENDED LOAD IS EXCEEDED.
- CARE MUST BE TAKEN WHEN FOLDING AND UNFOLDING THE PRODUCT TO PREVENT FINGER ENTRAPMENT.
- CAN BE USED FROM A NEWBORN BABY ONWARDS. A COCOON, SPECIALLY DESIGNED TO BE USED WITH A STROLLER, IS RECOMMENDED WHEN ANY FULLY RECLINING STROLLER IS USED WITH A NEWBORN.
- NEVER RUN WITH A NEWBORN BABY IN ANY PRAM OR STROLLER UNTIL THE CHILD CAN SIT UP UNASSISTED (APPROXIMATELY 6 MONTHS).
- CHECK ALL PARTS BEFORE USE FOR BREAKAGE OR FATIGUE. DISCONTINUE USE IMMEDIATELY IF ANY PART IS FOUND TO BE DAMAGED OR BROKEN.
- MAXIMUM LOAD OF BASKETS: 5KGS (11LBS).
- DO NOT CARRY ADDITIONAL CHILDREN.

**THIS STROLLER IS MANUFACTURED FOR USE WITH ONE CHILD ONLY**

- ALWAYS BE AWARE OF THE RISKS PROVIDED BY FIRE AND OTHER SIGNIFICANT SOURCES OF HEAT SUCH AS RADIATORS, ETC. WHICH MAY BE IN THE IMMEDIATE VICINITY OF YOUR STROLLER.
- IT MAY BE UNSAFE TO USE ANY ACCESSORIES OTHER THAN VALCO BABY APPROVED ONES.
- THIS PRODUCT IS INTENDED FOR DOMESTIC USE ONLY. IT IS NOT INTENDED FOR COMMERCIAL USE.

Should the chassis become wet, dry off promptly before storing. If this pram is used near the ocean or salted roads, spray the chassis and seat frame with water and dry. We recommend a rust inhibiting product should be used to prevent rust and fatigue on metal parts.

We recommend that you wipe down axles and lubricate the wheels every 3 months. Sand and dirt can grind down axles, if you live near the beach or in a dusty environment you must wipe down the axles and wheels then lubricate them monthly.

AXLES ARE BEST LUBRICATED WITH GREASE OR PETROLEUM JELLY. MOVING PARTS ARE BEST LUBRICATED WITH SILICONE BASED PRODUCTS. DO NOT USE OIL BASED PRODUCTS.

FURTHER INFORMATION:  
In North America only  
[www.valcobaby.com](http://www.valcobaby.com)

1800 610 7850  
[info@valcobaby.com](mailto:info@valcobaby.com)  
Find us on:



**valco**  
baby