

VISTA STROLLER SYSTEM CAR SEAT ADAPTER

GRACO SNUGRIDE®
OR SAFESEAT™ (FITS BOTH)

Model 0029

UPPAbaby

www.uppababy.com



1-800-760-2060
UPPAbaby
371 Liberty Street
Rockland, MA 02370

General Safety Information

- Read all instructions before using this product.
- Periodically check attachment by lifting up on adapter or car seat.
- Designed to fit all Graco Snugride® or SafeSeat™ infant car seats manufactured from the year 2002 until the date of this purchase.
- Maximum weight: Graco Snugride = 22 lbs, Graco SafeSeat = 30 lbs

! WARNING

- To prevent serious injury or death, install and use according to these instructions.
- Recommended only for infants within the height and weight limitations of Graco Snugride® or SafeSeat™ infant car seats.
- Intended for use with UPPAbaby VISTA stroller only.
- Always use infant car seat restraint system as recommended by manufacturer.
- Never leave child unattended.

To attach the adapter

- 1) Frame without seat or bassinet (figure 1).
- 2) Position the adapter with the 3 plastic parts away from the handle bars (figure 2). Snap in adapter firmly. Lock indicators on frame will appear green when fully inserted.



To attach the car seat

- 3) Snap in car seat firmly with seat facing the handle bars (figure 3).
- 4) Make sure that rear lock tab is engaged (figure 4). Lift up on car seat handle to check attachment.



To remove the car seat

- 5) Lift lever on back of seat while lifting car seat handle (figure 5).

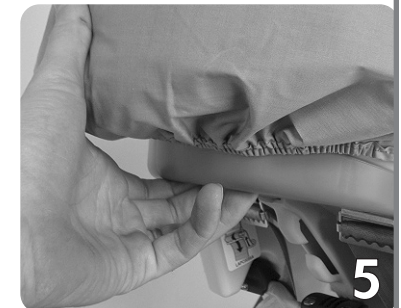

Limited Warranty

Your UPPAbaby product is warranted to be free from any manufacturing defects for a period of 1 year from the date of purchase under normal use and in compliance with the operating instructions. This warranty extends only to the original retail purchaser and is only valid when supplied with proof of purchase. Please retain proof of purchase with this Limited Warranty.

Please contact us at 800 760-2060 or service@uppababy.com if you have any questions regarding warranty.

Please note that a problem will not be covered by this warranty if the problem is caused by misuse or poor maintenance.